

15 YEAR RESIDENTIAL, 10 YEAR COMMERCIAL LIMITED WARRANTY
SLIP RESISTANT SURFACE
REVERSIBLE FINISH (SOFT GRAIN AND GROOVED)
MANUFACTURED 90% RECYCLED MATERIAL
CONCEALED SAFETY SECURING CLIPS AND FASTENING SYSTEM

HOMEDECK ANTI-SLIP BOARD RANGE IS PERFECT FOR BALCONY AND TERRACED AREAS. THE DURABLE AND LIGHTWEIGHT BOARD COMES WITH A LONG WARRANTY AGAINST WARPING, SPLITTING AND IS VIRTUALLY MAINTENANCE FREE ENSURING PIECE OF MIND WITH EACH INSTALLATION.

COMPONENTS

HomeDeck Composite
3600mm Length

| Article | Colour |
|---------------|----------|
| 5112313836-CB | Charcoal |
| 5112313836-GR | Grey |
| 5112313836-WN | Walnut |

138 x 23mm Profile

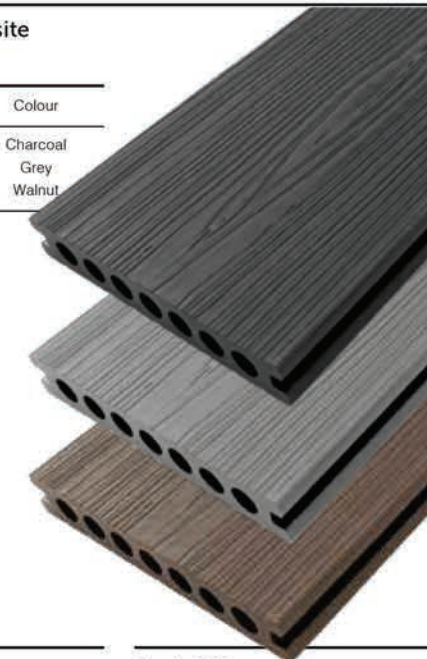

Edge Board
3600mm Length

| Article | Colour |
|---------------|----------|
| 5121501536-CB | Charcoal |
| 5121501536-GR | Grey |
| 5121501536-WN | Walnut |

150 x 15mm Profile



Angle Trim
2900mm Length

| Article | Colour |
|-------------|----------|
| 51342660-CB | Charcoal |
| 51342660-GR | Grey |
| 51342660-WN | Walnut |

42 x 42mm Profile



Coloured Fixings

| Article | Colour |
|--------------------|----------|
| 524CCSCREWS-OK-100 | Walnut |
| 524CCSCREWS-BH-100 | Grey |
| 524CCSCREWS-CB-100 | Charcoal |



Start Fastener

| Article | Pack |
|-----------------|------|
| 522STARTCLIP-50 | 50 |

Supplied with fixing screws.



Hidden Fastener

| Article | Pack |
|---------------|------|
| 521TCLIPS-250 | 250 |

Supplied with fixing screws.



Locking Clip

| Article | Pack |
|----------------|------|
| 523LOCKCLIP-50 | 50 |



Torx Drive

| Article | Pack |
|---------|------|
| 5 | Each |



HIGH STRENGTH
SLIP RESISTANT



MAINTENANCE
FREE



UP TO 15 YEAR
WARRANTY



LOW WATER
ABSORPTION



MANUFACTURED
USING RECYCLED
MATERIAL



HOMEDeck COMPOSITE SPECIFICATION

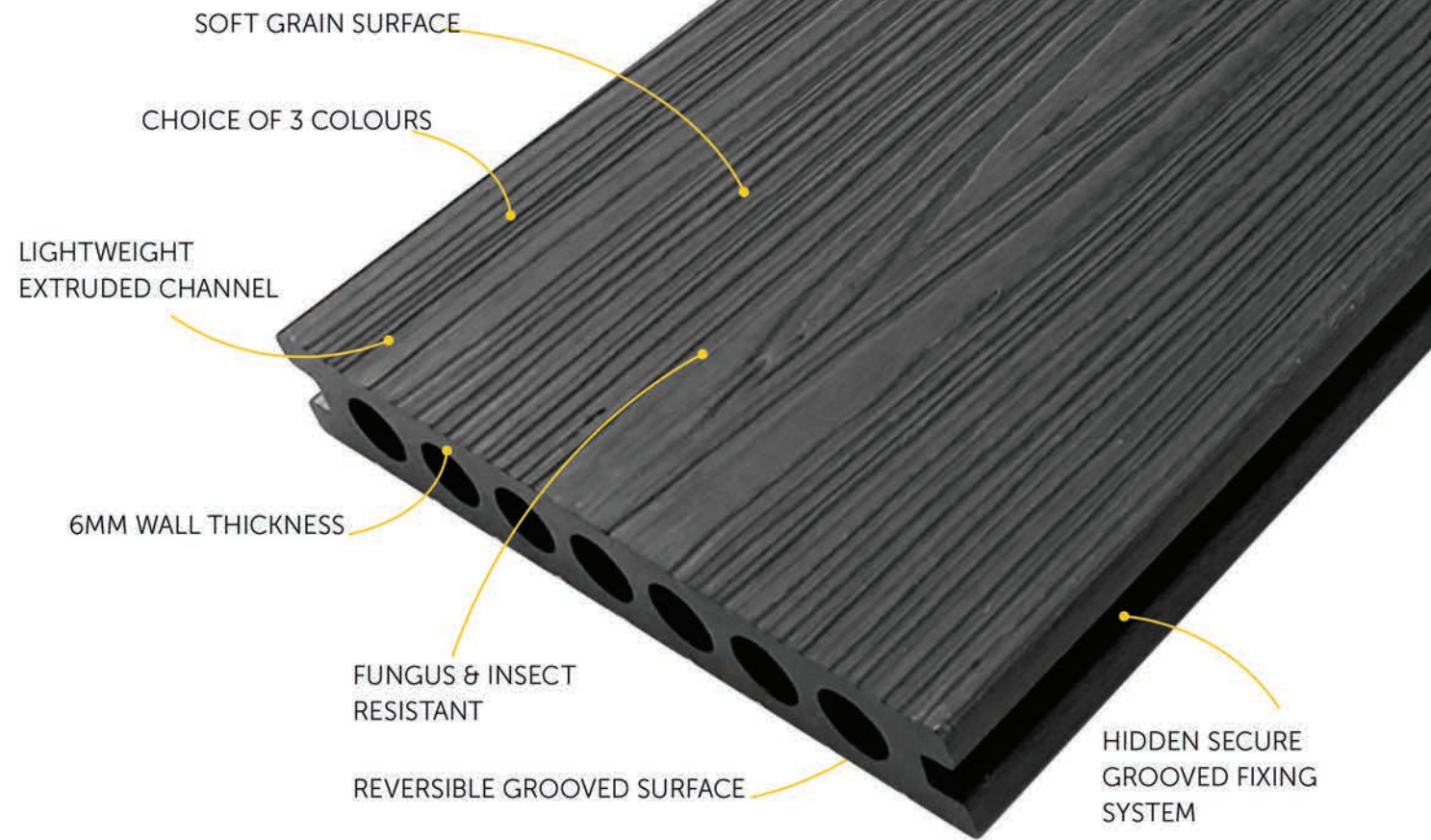

HomeDeck Composite Boards

| | | |
|---------------|--------------------------------|----------------------------|
| Hollow Sanded | 3600 x 138 x 23mm | Walnut, Graphite, Charcoal |
| Fascia | 3600 x 150mm x 15mm | Walnut, Graphite, Charcoal |
| Angle Trim | 2900 x 42mm x 42mm | Walnut, Graphite, Charcoal |
| Fixings | 22 Clips (Per m ²) | Stainless Steel |

Technical Specification

| Characteristics | Units | Test Reference |
|---|-------------------------|---------------------------------------|
| Density | 1.35 G/CM ³ | ASTM D792-08 |
| Tensile Strength | 155 KGF/CM ² | ASTM D638-08 |
| Elongation | 1.10% | TYPE I, V=5MM/MIN |
| Impact Strength | 7.6 KJ | SSTM D1037-93 |
| Nail - Head Pull -through | 346 KGF | ASTM D1036 |
| Flexural Modulus | 2.85 GPA | ASTM D1037-93 |
| Flexural Modulus After UV Ageing (1000 Hrs & Rain) | 2.82 GPA | ASTM D1037-93 |
| UV Ageing Test | PASS | ISO 4892-2 |
| Water Absorption (23°C, 24 Hrs. Increase In Weight) | 0.77% | ASTM D570-98 (2005) |
| Flammability Resistance (Standard) Composition | EURO CLASS CFL-S1 | BS EN 13501-1 |
| Thermal Expansion | 3.8x10 ⁻⁵ | ASTM D1037 |
| Sustainability | 90% RECYCLED MATERIAL | |
| Installation Temperature | °C | 10-20 |
| Joist spacing | mm | 400 (residential) 350 (commercial) |

HomeDeck Composite Features

| | Timber | Plastic | EazyDeck |
|--------------------------|--------|---------|----------|
| Wood-like appearance | • | - | • |
| 15 year warranty | - | - | • |
| Easy to work with | • | - | • |
| Low maintenance | - | • | • |
| Slip resistant | - | - | • |
| Anti-splinter | - | • | • |
| No warping | - | • | • |
| Environmentally sourced | - | • | • |
| Rod & woodwork resistant | - | • | • |
| Long-life | - | • | • |

Fixings

HomeDeck fixing system is hidden from view, which gives an evenly spaced fit and a seamless finish. This clever fixing system allows the boards to expand and contract naturally. All fixings are made from stainless steel. The fixing system comprises; starter clips, fixing clips and screws. You will need 4 starter clips from your first board and 20 fixing clips for each m².

HOMEDeck COMPOSITE INSTALLATION GUIDE

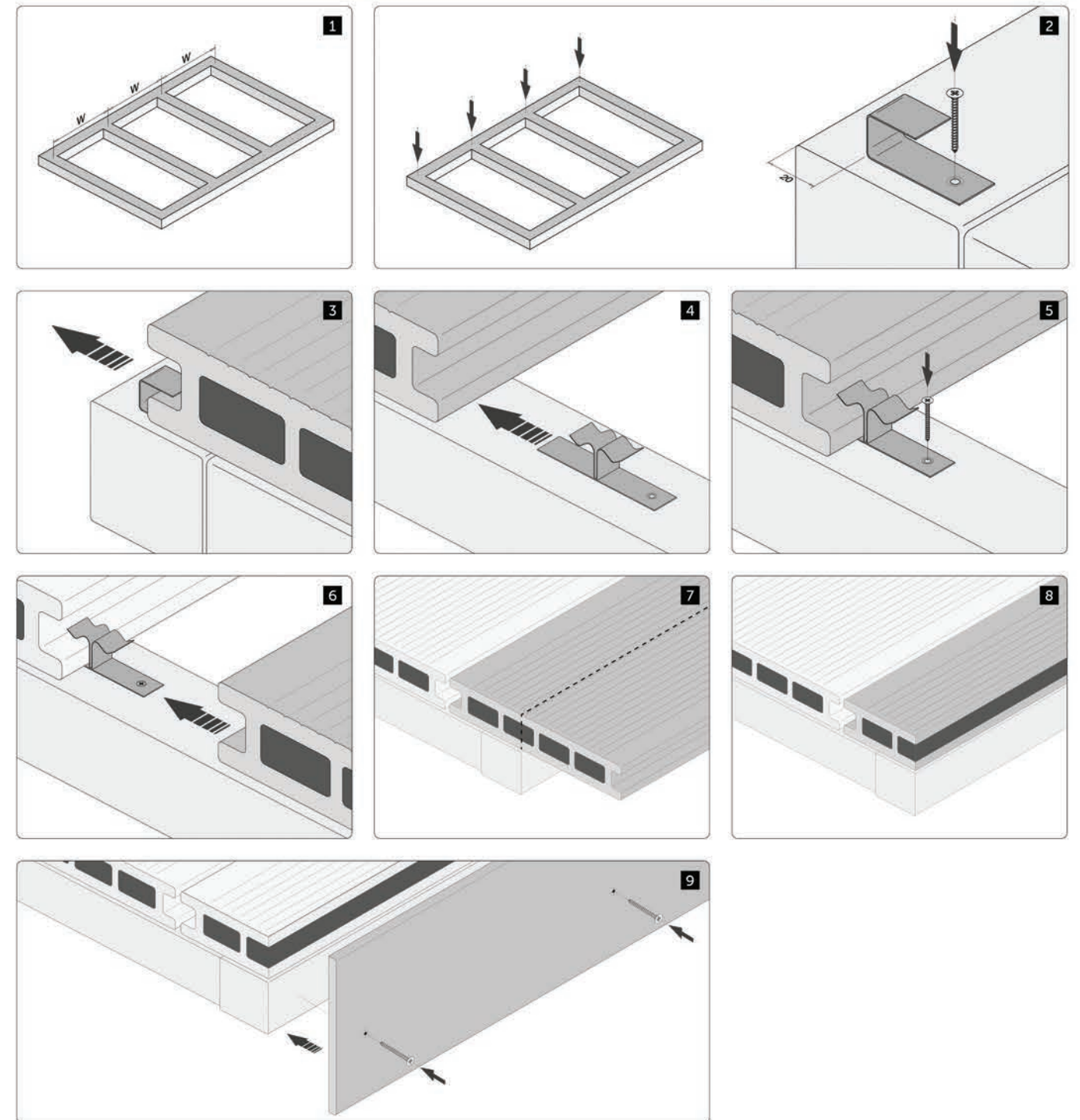

Care & Maintenance

Oil

Remove the oil as soon as possible and clean with a degreasing agent. Rinse with water and soap. If stains have set into the material, as with wood, they are hard to remove. Fine sandpaper can be used, following the grain.

Rust

Use water (and soap) and brush carefully with a scouring pad. In case of heavy rust, use a cleanser containing lemon and acid, then rinse with water.

Greasy Stains

Remove grease immediately and clean with a degreasing agent or soap. If stains have set to the material, as with wood, they are hard to remove. Fine sandpaper can be used, following the grain. Rinse with warm water.

Wine/Fruit Stains

Clean with a cleaning agent and water. For heavy stains scour with a light bleach and warm water. Rinse with water.

Scratches

In case of small scratches you can use fine sandpaper following the wood grain.

General Maintenance

Normal maintenance of the terrace can be done by sweeping or scrubbing the floor, or by using a hose or high-pressure cleaner. To avoid damage, make sure there is enough distance between the nozzle and EazyDeck decking. Test a small area first. Spray in the direction of the grain to avoid damage.